



Part #FRDF6772DR2
1967-72 Ford F Series Keyless Entry
Klassic Keyless Installation Guide

Step 1 - Unpack Klassic Keyless entry system and verify contents.

Remove all items from the shipping box. You should have the following before beginning:

- * (1) Keyless entry module
- * (2) Keyless entry remote controls
- * (2) Door lock actuators
- * (2) Door lock actuator mounting brackets (installed on actuators)
- * (2) Rubber doorjamb boots
- * (1) Wire harness
- * (2) Door lock actuator connecting rods (installed on actuators)
- * (2) Actuator connecting rod retaining clips (1 black-dr. side, 1 tan-pass. side)
- * (2) Lock knob rod large retaining clips (1 black-dr. side, 1 white-pass. side)
- * (4) Blue female bullet crimp connectors
- * (3) T-taps (2 blue and 1 yellow)
- * (2) Black plastic hole grommets
- * (2) 6" pieces of split loom
- * Wire zip ties



Step 2 - Gather the required tools.

Please gather the following tools before you begin the installation:

- * Power Drill
- * Angle Drill
- * (3) Drill bits (3/16", 7/16", Step drill bit)
- * Wire connector crimping tool
- * (3) Phillips head screw drivers (#2, #3 and right angle)
- * Ratchet and (4) sockets (11/32", 3/8", 7/16", 1/2")
- * Door panel clip tool
- * Tape Measure
- * Pliers
- * Sharpie Marker
- * Center Punch



Step 3 - Disassembly of doors on truck.

- A.** Roll door window all the way up then remove window crank with phillips head screwdriver.
- B.** Remove interior armrest from door by removing (3) 3/8" bolts from underside.
- C.** Unbolt (2) 11/32" nuts to remove interior door handle.
- D.** Use door panel clip tool to pry off chrome moulding around door panel.
- E.** Use phillips head screwdriver to remove screws around the perimeter of the inner door panel.
- F.** Remove inner door panel.
- G.** Repeat **steps A-F** for passenger side of truck.

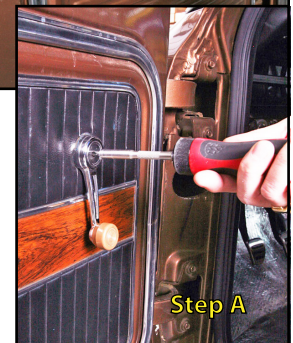
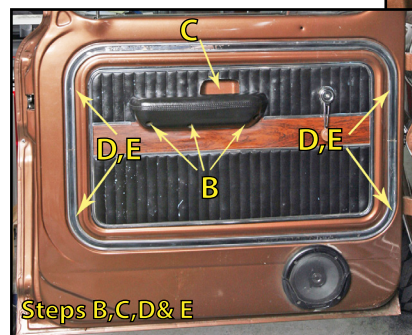

Step 4 - Drill one hole in front door end and one hole through door jamb.

- A. Locate factory dimple in the end of the door. With $3/16''$ drill bit in the angle drill, place drill outside of the door pointed to the rear at dimple.
- B. Drill pilot hole through the front of the door.
- C. Replace $3/16''$ drill bit with $7/16''$ bit and enlarge the hole.
- D. Moving to the door jamb, measure $4''$ down from dimple in door jamb and $1''$ in from outer edge and mark using a sharpie marker. Use center punch tool to dimple metal for drill.
- E. With $3/16''$ drill bit in the regular drill, drill pilot hole through the door jamb.
- F. Replace $3/16''$ drill bit with $7/16''$ bit and enlarge the hole.

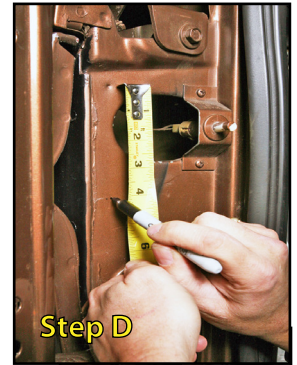
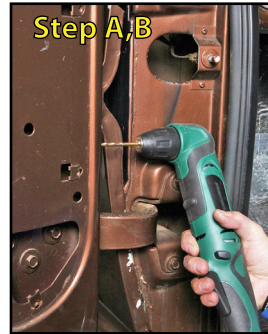

Step 5 - Remove kick panel vent and drill one hole through kick panel.

- A. Use #3 phillips head screw driver to remove the bolt holding the park brake on and gently move it to the right out of the way. (Note: test truck had aftermarket bolt instead of phillips head screw.)
- B. Remove phillips head screws from inner kick panel with standard and right angle screw drivers and remove the panel.
- C. Drill $3/16''$ pilot hole, straight back from the screw hole under the dash, from the kick panel out through 1 layer of metal into inner kick panel, then enlarge with $7/16''$ bit.
- D. Using step drill bit, enlarge inside hole to $1/2''$ and snap in supplied plastic grommet. (Screwdriver is only used to point to the grommet)

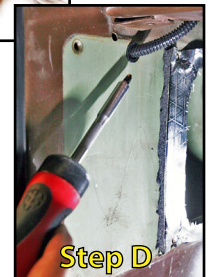
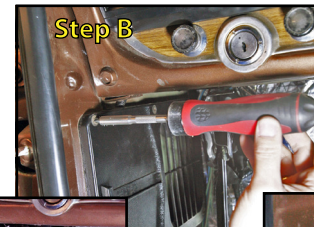

Step 6- Install door lock actuator.

- A. Using a $7/16''$ socket, loosen and remove the window guide bolt below the door latch on the door end.
- B. Inside the door, remove the lock knob rod from the clip holding it to the door latch by rotating the clip. Remove original clip from the door latch.
- C. Insert large black retaining clip (white clip on the passenger side) into the loop on actuator rod.
- D. With door lock actuator and bracket inside door, snap the black retaining clip into the hole on the door latch.

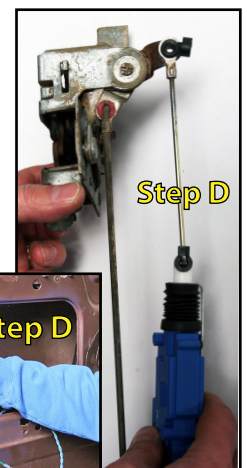
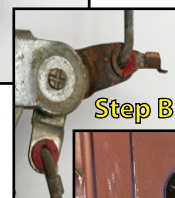
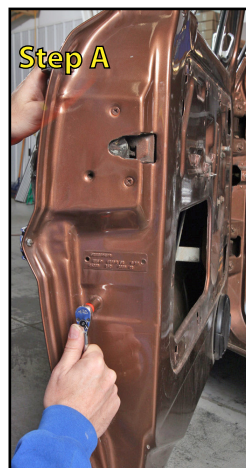

NOTE: Latch is removed from door for photographic purposes only. Do not remove latch for keyless installation.

Step 6- Install door lock actuator. (Continued)

- E. Insert the lock knob rod into the large black retaining clip and twist the clip so it locks onto the rod.
- F. Slide bracket attached to the actuator under the window guide and reinstall the bolt thru the large bracket hole into the window guide from the outside of the door. Tighten with ratchet and socket.

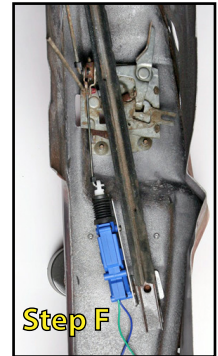
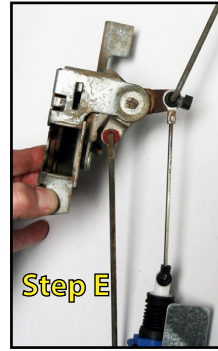

Step 7 - Repeat steps 4, 5 and 6 on passenger side of truck.

- A. Repeat steps 4, 5 and 6 on passenger side of truck using the second actuator, bracket, and rod. (Use large white retaining clip on passenger side)

Step 8 - Route and connect wires to door lock actuators.

- A. Unroll supplied wire harness and determine which pair of blue and green (**BG**) wires is shortest.
- B. Starting under the driver's side dash, near the ignition switch, loop short pair of **BG** wires over parking brake and route close to the kick panel.
- C. Insert **BG** wires through hole drilled in kick panel and out hole in door jamb into the doorjamb area.
- D. Find supplied rubber doorjamb boot and run **BG** wire through the boot.
(Note: do not loop wires around door check or hinges)
- E. Insert **BG** wires through hole drilled in door end and route down low inside of door toward door latch area being careful to avoid window mechanism.
- F. Retwist and insert stripped end of one wire into the **small end** of a blue bullet connector supplied in kit. Using crimping tool, crimp connector onto wire. Repeat for other wire.
- G. Plug blue wire of actuator into the connector on the blue wire from the harness. Repeat connecting green wire to green wire.
- H. Insert ends of doorjamb boot into holes in door and jamb up to the first ring on boot to protect wires from chafing. Pull slack in wire toward interior of car.
- I. Route long **BG** wires through the underside of the dashboard over to the passenger's side kick panel taking care not to catch wires in any moving mechanisms.
- J. Repeat **steps C-H** on passenger side door.

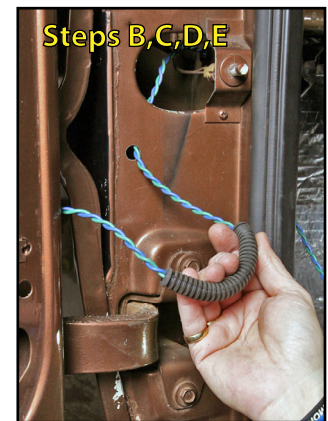

Step 9 - Connect wire harness to ignition harness and keyless entry module.

- A. Using the 1/2" socket and ratchet, remove the left side lower steering column bolt, put bolt through the ground loop (ring terminal tagged **GROUND**) on the keyless entry wire harness and replace and tighten bolt.

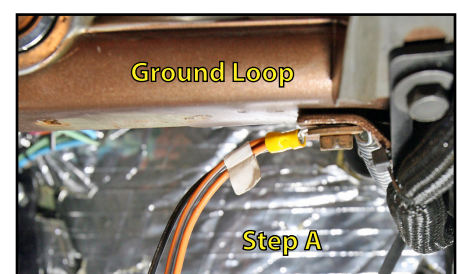

Step 9 - Connect wire harness to ignition harness and keyless entry module. (Continued)

- B.** Locate wiring harness plugged into the back of the factory ignition switch. Remove any electrical tape wrapped around wiring and find the yellow wire.
 - C.** Take the yellow T-tap from the parts bag and place it on the yellow ignition switch wire in the groove on the side without the metal clip.
 - D.** Fold over the T-tap and squeeze with pliers until it makes click sound.
 - E.** Plug in the red and yellow wires tagged **+12V** from the keyless entry harness to the yellow T-tap.
 - F.** Locate wiring harness plugged into the back of the factory headlight switch. Remove any electrical tape wrapped around wiring and find the dark brown wire and black with yellow stripe wire.
 - G.** Take one blue T-tap from the parts bag and place it on the dark brown wire in the groove on the side without the metal clip.
 - H.** Fold over the T-tap and squeeze with pliers until it makes click sound.
 - I.** Repeat **steps G and H** for the black with yellow stripe wire.
 - J.** Plug in the double ended pink wire tagged **PARK LIGHTS** from the keyless entry harness to the 2 blue T-taps. (Order does not matter.)
- NOTE: T-taps and wires in photos do not match description.**
- K.** Put supplied split loom tubing over **BG** wires going into kick panel on each side.

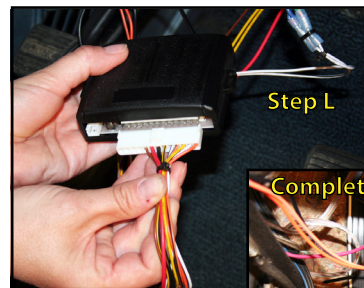
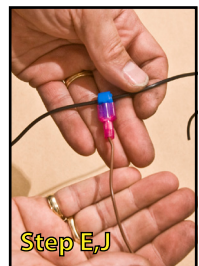
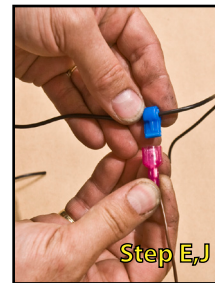

- L.** After all connections are made to truck then plug harness into keyless entry module (black box).
- M.** Test keyless entry by pressing buttons on remotes. Top button should lock doors and flash park lights one time. Bottom button should unlock doors and flash park lights twice (Note: on some vehicles only the tail lights will flash).
- N.** If all works correctly, use supplied zip ties to secure module, wires in both doors, and wires under dashboard.

Step 10 - Reassemble vehicle.

- A.** Reinstall door panels, kick panels, handles, and arm rests, checking that keyless entry works after each piece has been reinstalled to make sure no wires have been pinched.
- B.** Once everything has been reinstalled and keyless entry works, your installation is complete. Enjoy the convenience of keyless entry on your classic truck.

Klassic Keyless

For Questions or Comments
Please Log On To www.KlassicKeyless.com
Or Call 402-502-6926

This manual is property of Klassic Keyless LLC. Any unauthorized duplication or use without written permission from Klassic Keyless LLC, violates Copyright laws.
Copyright © 2010 Klassic Keyless LLC. All Rights Reserved.