



Part #FRDB6777DR2  
1967-77 Ford Bronco Keyless Entry  
**Klassic Keyless Installation Guide**

**Step 1 - Unpack Klassic Keyless entry system and verify contents.**

Remove all items from the shipping box. You should have the following before beginning:

- \* (1) Keyless entry module
- \* (2) Keyless entry remote controls
- \* (2) Door lock actuators
- \* (2) Door lock actuator mounting brackets (installed on actuators)
- \* (2) Rubber doorjamb boots
- \* (2) 6" pieces of split loom
- \* (2) Plastic grommets
- \* (1) Wiring harness
- \* (2) Door lock actuator connecting rods (installed on actuators)
- \* (2) Actuator connecting rod retaining clips (1 black-dr. side, 1 tan-pass. side)
- \* (2) Lock knob rod large retaining clips (1 white-dr. side, 1 black-pass. side)
- \* (4) Blue female bullet crimp connectors
- \* (2) Wire T tap, (1) Blue, (1) Yellow
- \* Wire zip ties

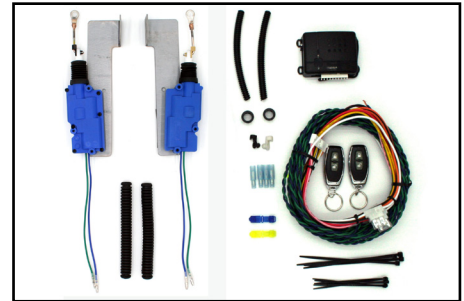

**Step 2 - Gather the required tools.**

Please gather the following tools before you begin the installation:

- \* Power Drill
- \* (3) Drill bits (**3/16"**, **7/16"**, **1/2"**) (Step drill optional)
- \* Wire connector crimping tool
- \* (2) Phillips head screw drivers (**#2**, **#3**)
- \* Ratchet and (2) Sockets (**11/32"**, **1/2"**)
- \* Door panel clip tool
- \* Pliers



**Step 3 - Disassembly of door panels on car.**

- A.** Roll door window all the way up.
- B.** Remove window crank but removing 1 phillips head screw.
- C.** Remove interior armrest from door by using large (#3) phillips head screwdriver to remove 3 screws from underside.
- D.** Use **11/32"** socket and ratchet to remove 2 bolts from inner door handle and remove handle.
- E.** Use door panel clip tool to pry edges of door panel loose and remove panel.
- F.** Gently pull away weather shield from door (if present).
- G.** Repeat steps A thru F for passenger side of car.

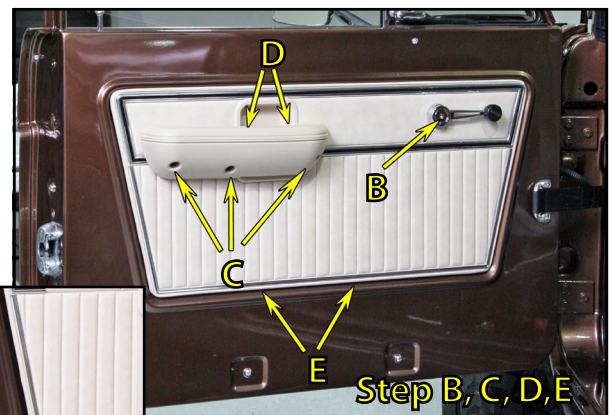

## Step 4 - Drill three holes, one in door end, one in door jamb and one in kick panel.

- A. Remove door strap bracket from door by removing 2 phillips head screws.
  - B. Drill  $3/16$ " pilot hole through kick panel between 2 screws for the inner door strap bracket. Use step drill bit or  $1/2$ " bit to enlarge hole to  $1/2$ ". Snap a supplied plastic grommet into the hole.
  - C. With door propped all the way open, drill  $3/16$ " pilot hole through door jamb just across from the kick panel hole then enlarge to  $7/16$ ".
- NOTE:** Make sure the door doesn't open too far causing damage to door or fender.
- D. Drill  $3/16$ " pilot hole in the door end in the center of the door just below the hinge then enlarge to  $7/16$ ".

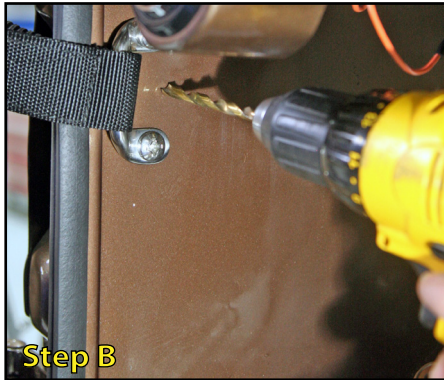

## Step 5 - Install door lock actuator.

- A. Using a large #3 screw driver, loosen the top screw and remove the two bottom screws attaching the door latch to the door.
- B. With door lock actuator and bracket inside door, slide bracket under door latch so the large hole straddles the cone shaped hole that is closest to the inside of door.
- C. Reinstall and tighten door latch mounting screws.
- D. Locate the factory door lock knob rod and twist the metal clip to release the rod from the latch. Remove metal and plastic clips from door latch.
- E. Insert large white retaining clip (black clip on the passenger side) into the loop on actuator rod.
- F. Snap the white retaining clip into the hole on the door latch. Insert the lock knob rod into the large white retaining clip.
- G. Twist the clip so it locks onto the rod.

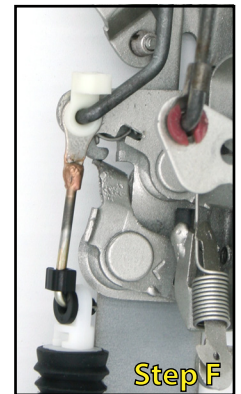
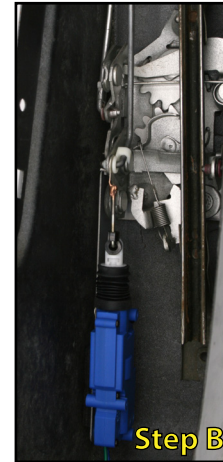

**NOTE:** Latch is removed from door for photographic purposes only. Do not remove latch for keyless installation.

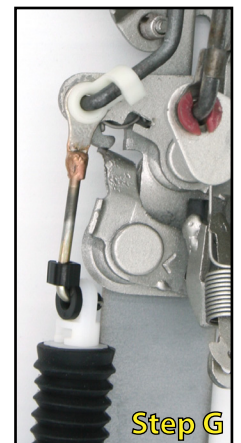
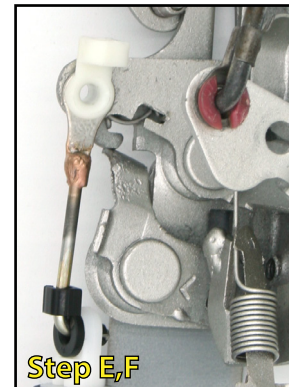
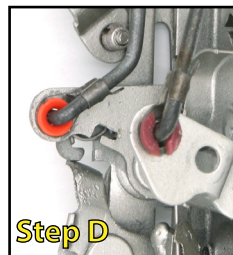

## Step 6 - Repeat steps 4 and 5 on passenger side of car.

- A. Repeat steps 4 and 5 on passenger side of car using the second grommet, actuator, bracket, rod, and yellow retaining clip.



## Step 7 - Route and connect wires to door lock actuators.

- A. Unroll supplied wire harness and determine which pair of blue and green (**BG**) wires is shortest.
- B. Starting under the driver's side dash, near the ignition switch, loop short **BG** wires over the steering column and through the hole drilled in the kick panel and out the door jamb hole into the door jamb area.
- C. Find supplied rubber doorjamb boot and run **BG** wires through the boot.

**Note: Do not loop wires around door check or hinges**

- D. Insert **BG** wires through hole drilled in door end and route along outside face of door toward door latch area being careful to avoid window mechanism and screw mounting holes in door.
- E. Retwist and insert stripped end of one wire into the **small end** of a blue bullet connector supplied in kit. Using crimping tool, crimp connector onto wire. Repeat for other wire.
- F. Route actuator wires behind window channel in door. Plug blue wire of actuator into the connector on the blue wire from the harness. Repeat connecting green wire to green wire.
- G. Insert ends of doorjamb boot into hole in door and cowl up to the first ring on boot to protect wires from chafing. Pull slack in wire toward interior of car.
- H. Zip tie wires to door shell as needed.
- I. Route long **BG** wires through the underside of the dashboard over to the passenger side kick panel taking care not to catch wires in any moving mechanisms.
- J. Repeat steps B thru H on the passenger side of car.

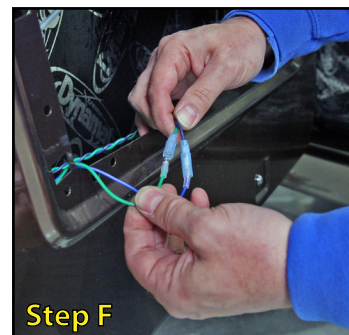
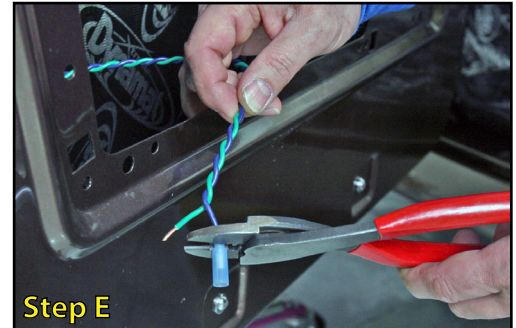

## Step 8 - Connect wire harness to ignition wiring and keyless entry module.

- A. Using a screw driver, remove screws from the steering column cover and remove the cover.
- B. Using  $1/2$ " socket and ratchet remove right side bolt from upper steering column mount and bolt ground eyelet on wire harness to dashboard using original bolt.
- C. Clip yellow t-tap onto yellow **+12V** wire from back of ignition switch and plug in yellow male spade terminal (Red and yellow wires tagged **+12V**) on keyless wire harness. (see Step 9 for t-tap usage)
- D. Reinstall the steering column cover.

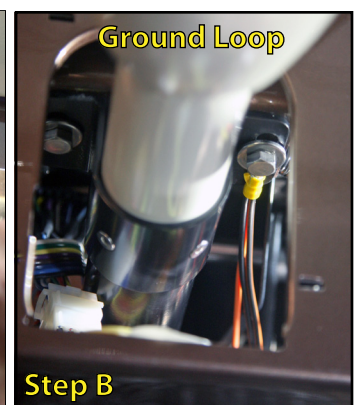

## Step 9 - Parking light hook up (Optional).

- A.** Locate wiring harness plugged into the back of the factory headlight switch. Remove any electrical tape wrapped around wiring and find the black with yellow stripe wire.
- B.** Take the blue t-tap from the parts bag and place it on the black with yellow stripe wire with the wire in the groove on the side without the metal clip.
- C.** Fold over the t-tap and squeeze with pliers until it makes click sound.
- D.** Plug in the pink wire tagged **LAMPS** from the keyless entry harness to the T-tap.
- E.** Plug wire harness into keyless entry module.
- F.** Press the lock button on the remote, the parking lights will flash once and lock the doors. Press the unlock button and the parking lights will flash twice and unlock the doors.
- G.** Put supplied split loom tubing over **BG** wires going into kick panel on each side.
- H.** If all works correctly, then use supplied zip ties to secure module and wires in both the doors and under the dashboard. Zip tie module to the ignition harness.



**NOTE: Wires in photos do not match description.**

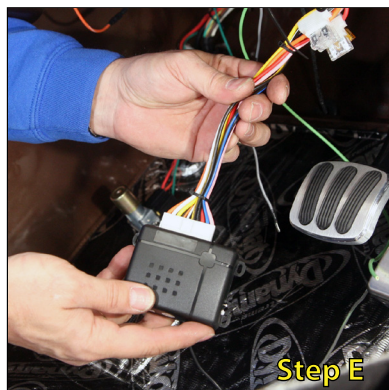
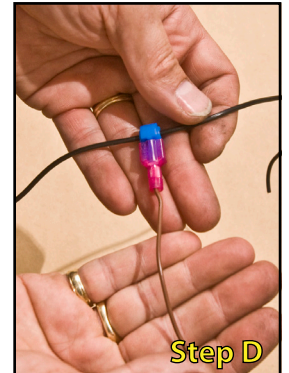
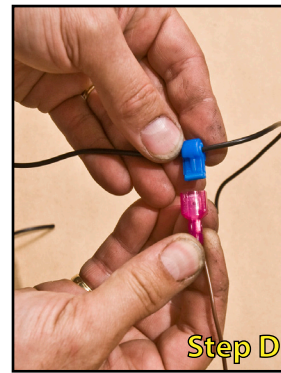
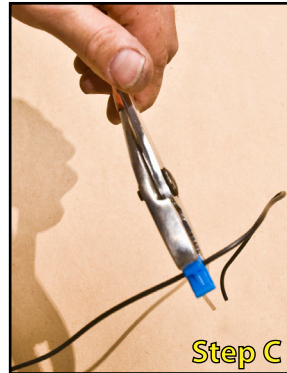

## Step 10 - Reassemble vehicle.

- A.** Reinstall weather shields, door panels, handles, arm rests, door straps and brackets, checking that keyless entry works after each piece has been reinstalled to make sure no wires have been pinched.
- B.** Once everything has been reinstalled and keyless entry works, your installation is complete. Enjoy the convenience of keyless entry on your classic Bronco.

# Klassic Keyless

For Questions or Comments  
Please Log On To [www.KlassicKeyless.com](http://www.KlassicKeyless.com)  
Or Call 402-502-6926

This manual is property of Klassic Keyless LLC. Any unauthorized duplication or use without written permission from Klassic Keyless LLC, violates Copyright laws.  
Copyright © 2010 Klassic Keyless LLC. All Rights Reserved.